

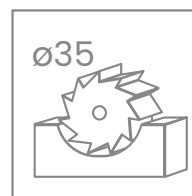

PRO SPRÁVNOU MONTÁŽ POTŘEBUJETE NÁSLEDUJÍCÍ NÁŘADÍ:
FOR CORRECT ASSEMBLY YOU NEED TOOLS:

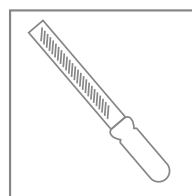
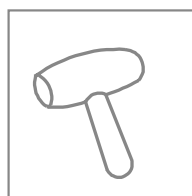
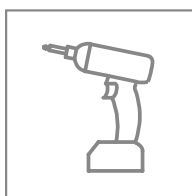
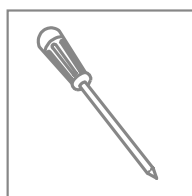
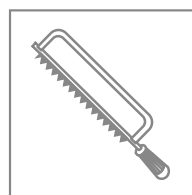
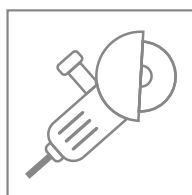
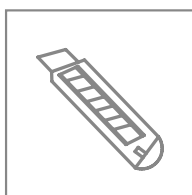
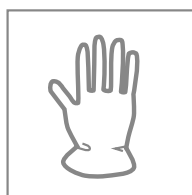

Souprava vrtáků:
Drills set:

ø2-ø10

Souprava bitů:
Bits set:

Souprava imbusových klíčů:
Allen keys set:

1,5-5

Deska 18 mm / Board 18 mm

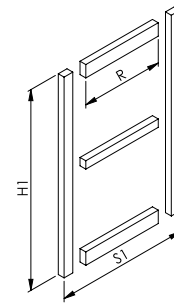
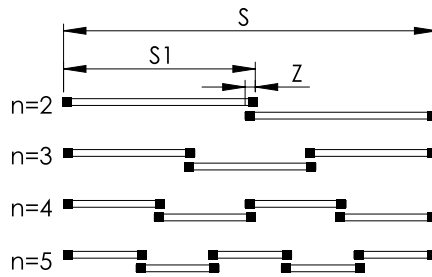
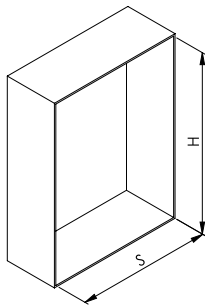

Z - přesah mezi křídly
Z - overlap between door leaves

H1 - celková výška hotového křídla
H1 - total height of finished door leaf

n - počet křídel zahrnutých do výpočtů
n - number of door leaves that are calculated

S1 - celková šířka hotového křídla
S1 - total width of finished door leaf

R - délka vodorovných profilů
R - length of horizontal profiles

* všechny rozměry jsou uvedeny v mm
* all dimensions are in mm

Druh úchytu Handle type		Šířka dveřního křídla - S1 Width of door leaf - S1	Výška dveřního křídla - H1 (délka svislých profilů) Height of door - H1 (length of vertical profiles)		Délka vodorovných profilů - R Length of horizontal profiles - R	
Přesah Overlap	Z	Počet křídel - n Quantity of door leaves - n	Vodící kolejnice RAMA Rama track	Vodící kolejnice GAMA Gama track		
DELTA 88900000 	22	n=2 $S_1 = (S+Z)/2$ n=3 $S_1 = (S+2 \times Z)/3$	H1=H-40 	H1=H-47 	R=S1-39,4	PROFIL C-18 PROFIL TVARU C C-18 profile 88660000 OZDOBNÝ ÚHELNIK L10/20 L10/20 decorative angle profile 88640000
INTERO 88130000 	34	n=4 $S_1 = (S+3 \times Z)/4$ n=5 $S_1 = (S+4 \times Z)/5$				R=S1-62,8

Výpočet šířky - druh výplně / Width calculation - filling type

i - Pro více informací kontaktujte prosím obchodní oddělení
- contact our sales department for additional information

Bp - šířka desky
Bp - board width

Druh úchytu / Handle type	Deska 18 mm / Board 18 mm
DELTA 88900000 	$Bp = S_1 - 2,1$
INTERO 88130000 	$Bp = S_1 - 16$

Výpočet výšky výplň / Filling height calculations

Hp - výška desky
Hp - board height

H1 - celková výška hotového křídla
H1 - total height of finished door leaf

 Deska/Board

DESKA 18 MM / Board 18 mm

$$H_p = H_1 - 2$$

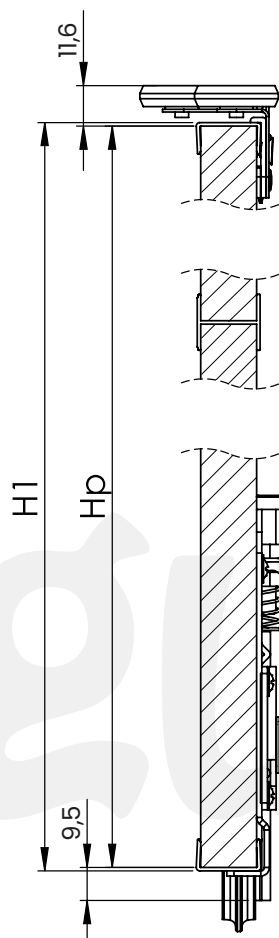

Další informace pro dělené křídlo se spojovacím profilem
Additional information on separating the door leaf with a connecting profile

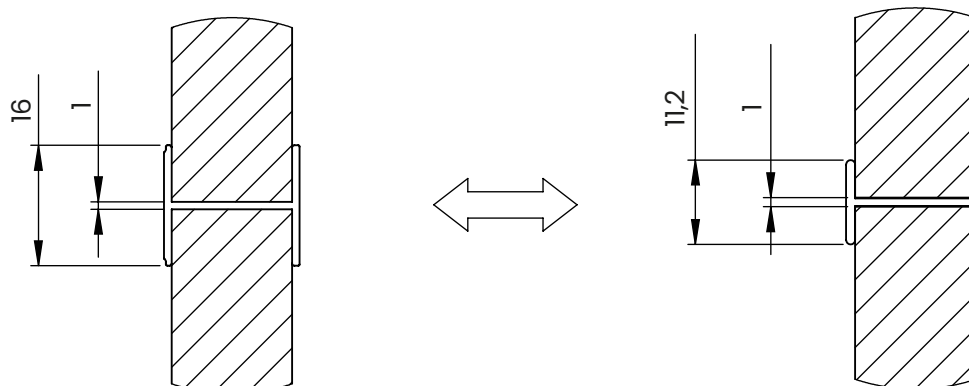

Druh vodící kolejnice Track type	Výběr typu dolního kování / Lower hardware type selection Kování jsou vzájemně zaměnitelná Hardwares are interchangeable		
	 <p>100 mm 50 mm</p> <p>SPRING RAMA 88810100</p>	 <p>100 mm 50 mm</p> <p>SPRINART RAMA 88811200</p>	
	 <p>100 mm 50 mm</p> <p>SPRING GAMA 88811100</p>	 <p>100 mm 50 mm</p> <p>SPRINART GAMA 88811300</p>	 <p>100 mm 50 mm</p> <p>SLIM 88800000</p>

Frézování otvorů pro kování / Hole milling for the hardware

Doporučené šrouby pro dolní kování / Recommended screws for bottom hardwares

Montáž ostatního kování / Mounting other hardwares

Vrut / Screw U-P-3,5x10-PH-O-B-5.8-0

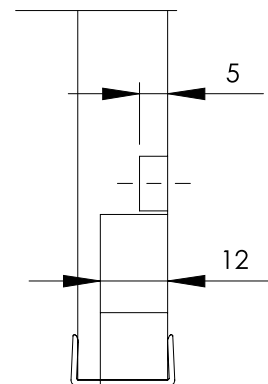
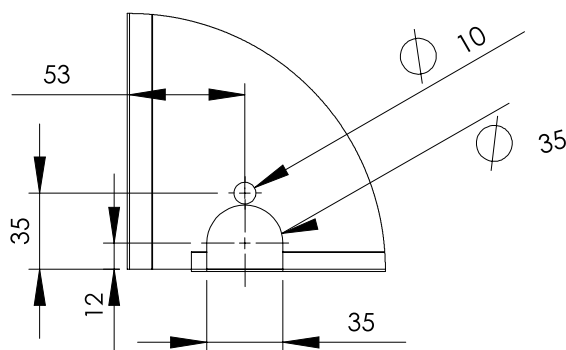
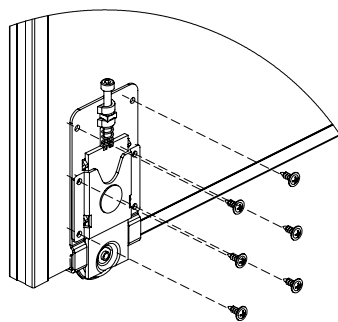
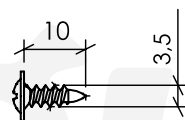

Montáž křídla - Deska 18 mm / Door leaf assembly - board 18 mm

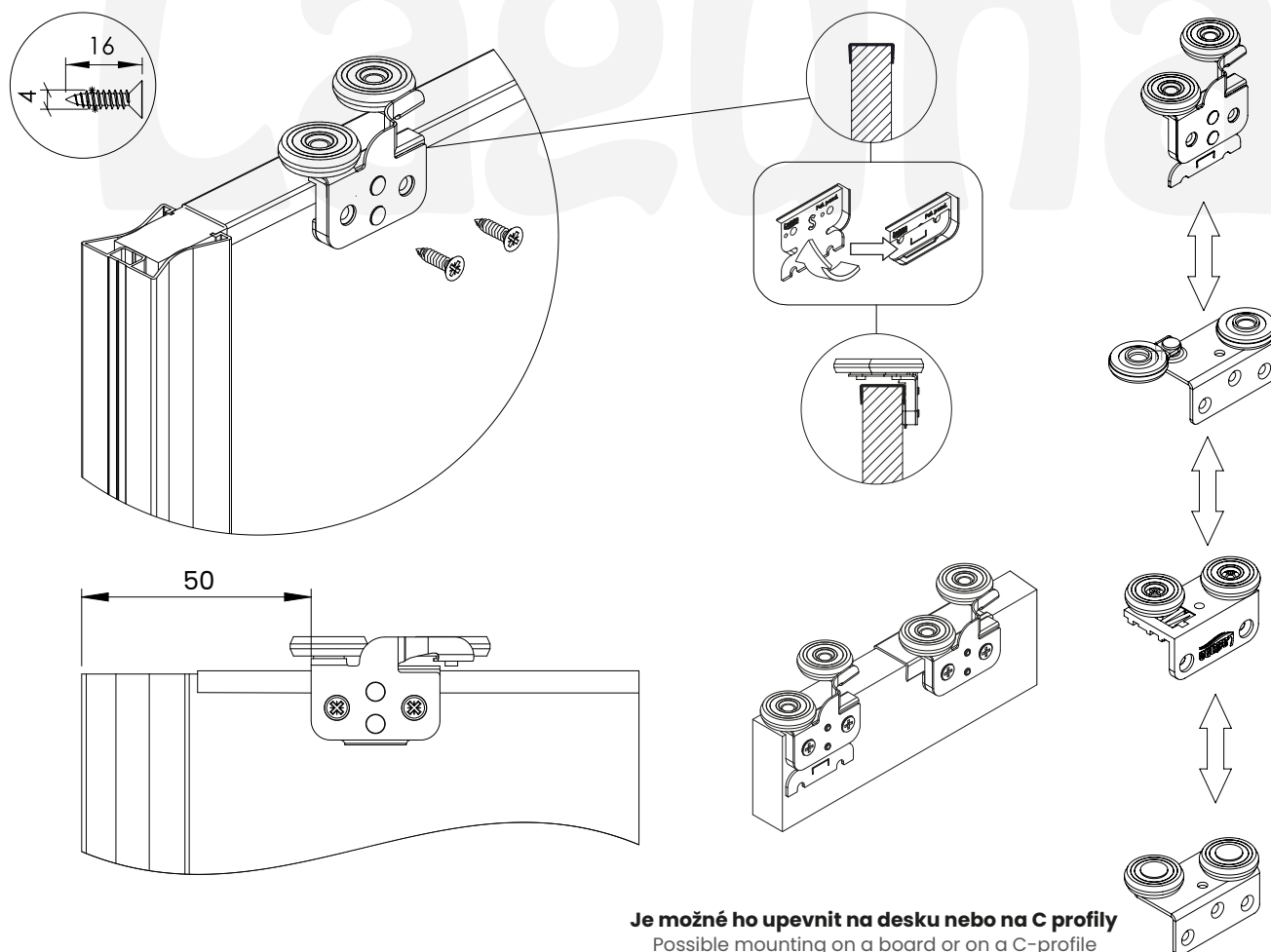
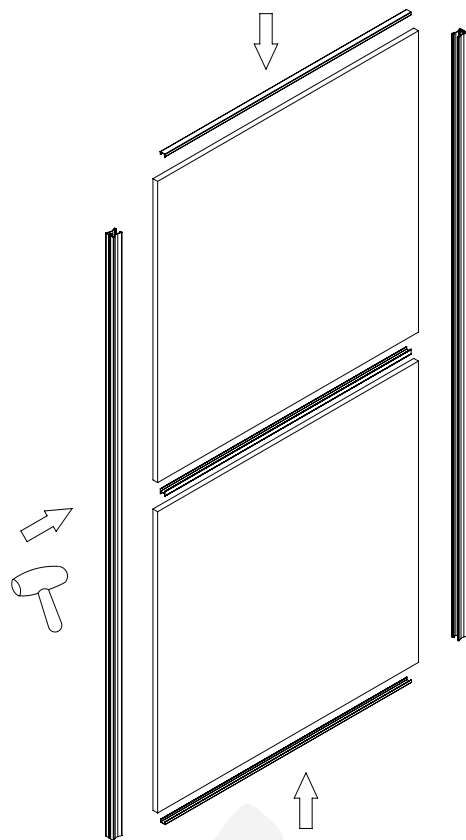

Je možné ho upevnit na desku nebo na C profily
Possible mounting on a board or on a C-profile

Montáž horních vodicích kolejnic / Mounting of upper tracks

(příčný průřez) / (cross section)

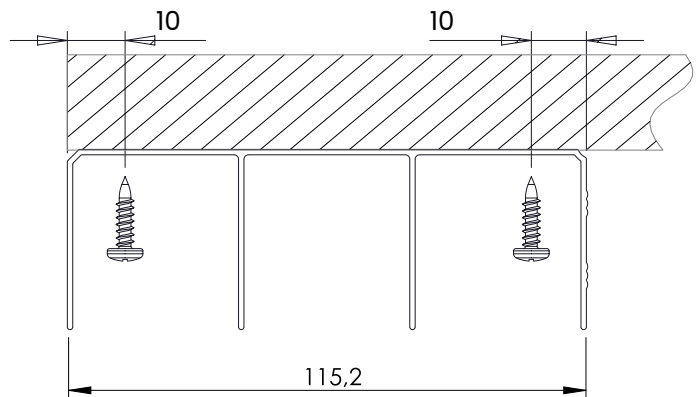
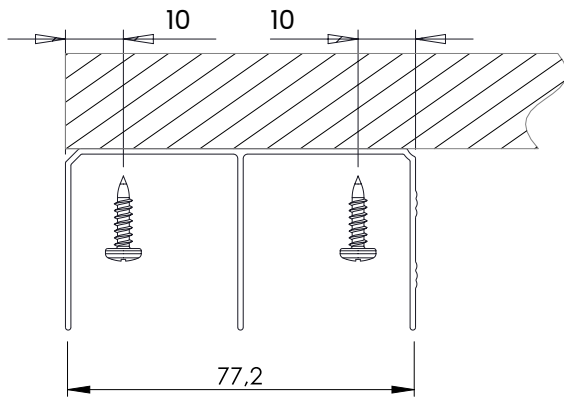

Orientace vzhledem k horním vodicím kolejnicím

Position relative to the upper track

VODICÍ KOLEJNICE RAMA / Rama tracks

VODICÍ KOLEJNICE GAMA / Gama track

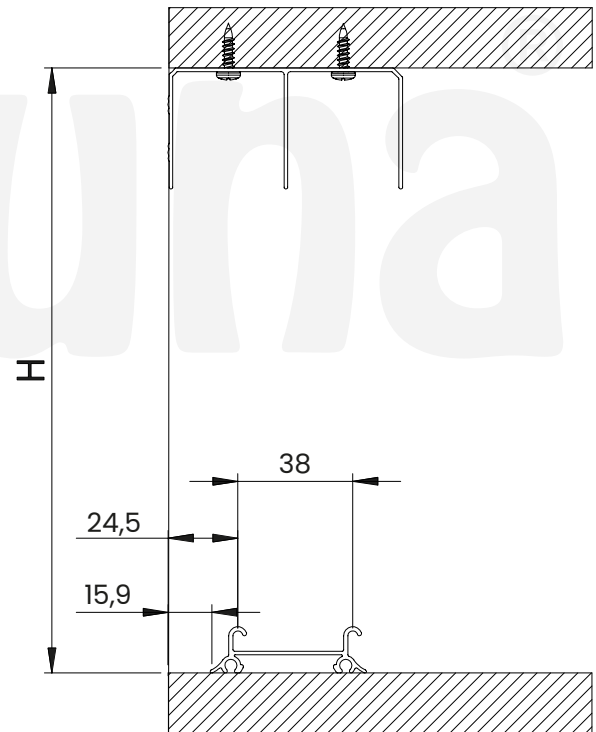
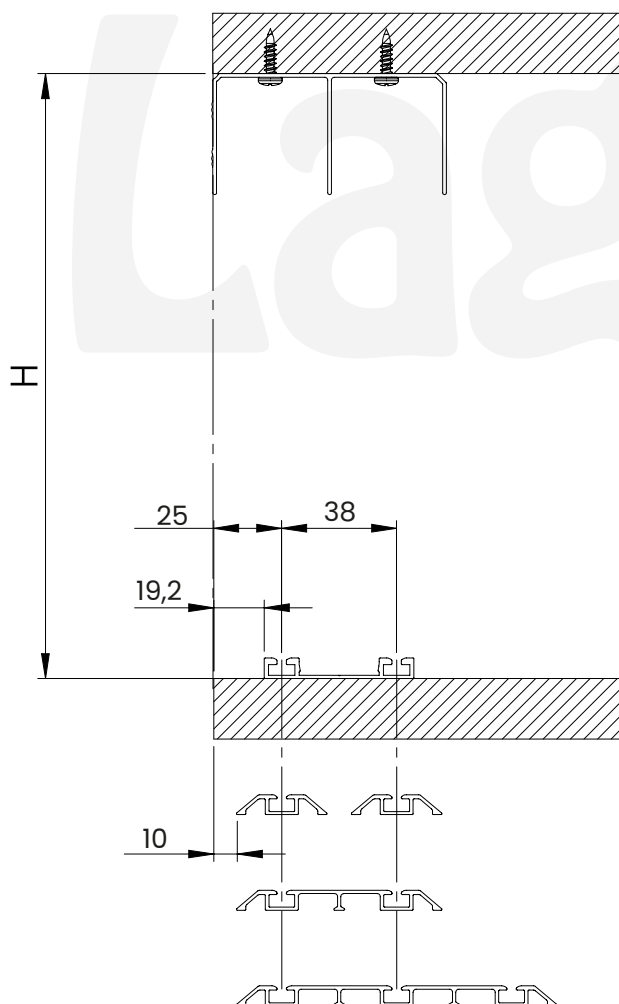

Montáž dolních vodicích kolejnic / Mounting of lower tracks

VODICÍ KOLEJNICE RAMA / Rama tracks

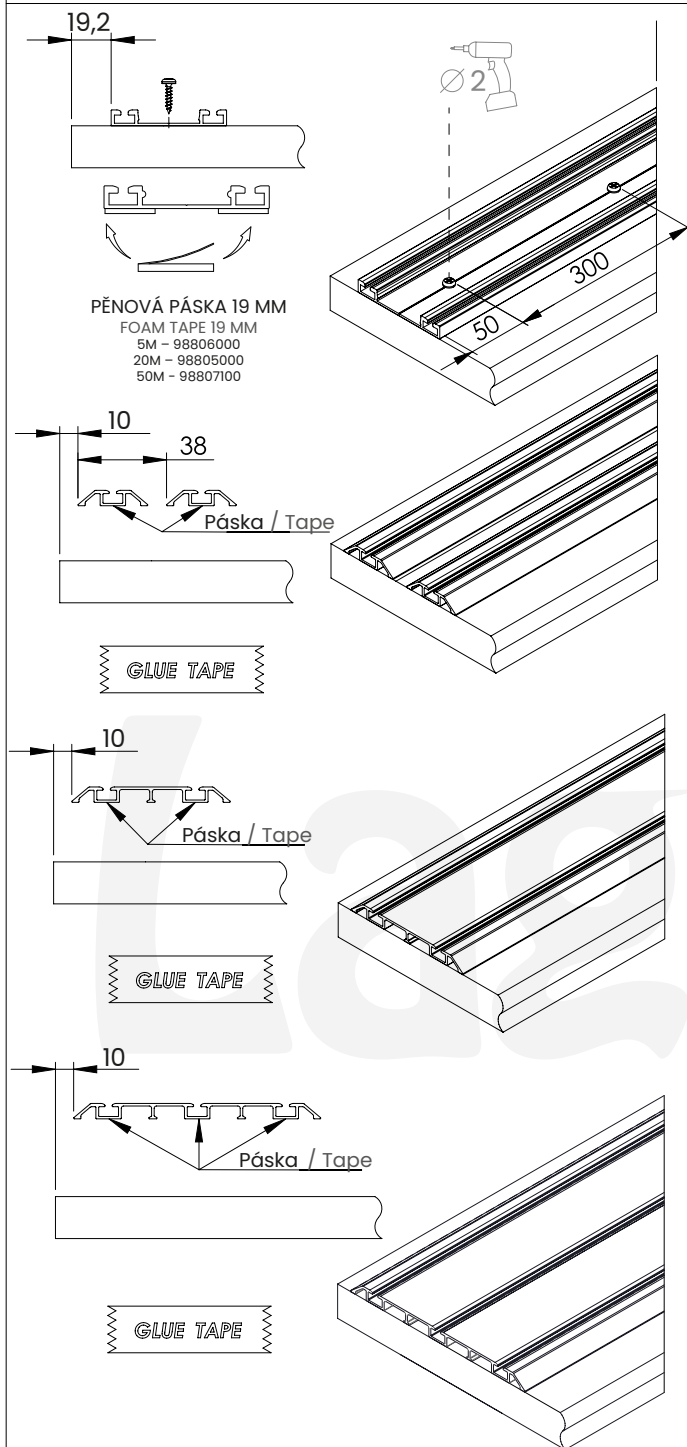

VODICÍ KOLEJNICE GAMA / Gama track

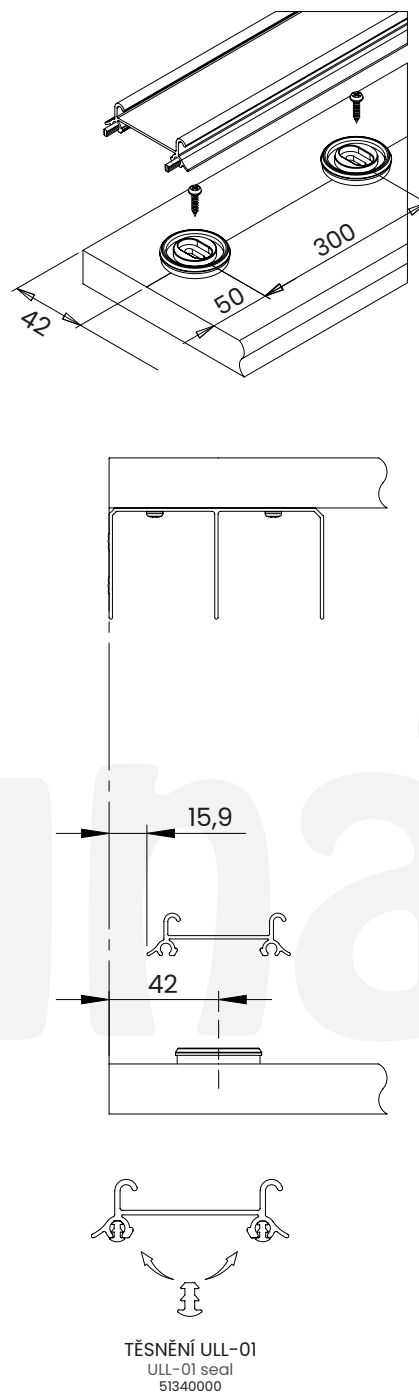

Montáž dolního dorazu ve vodicích kolejnicích rama / Mounting of lower stopper in rama tracks

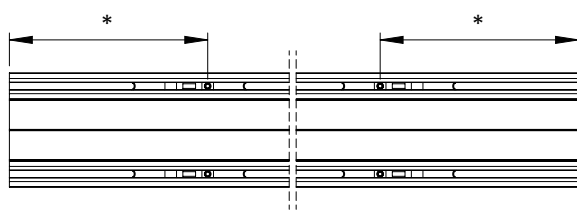

* Nastavte vzdálenost dorazu tak, aby se křídlo po zasunutí gumových kroužků kování do válcové části dorazu zavřelo až k okraji rámu systému.

* Set the stopper distance so that the door leaf is closing to the edge, after placing the bearing of the hardware in the cylindrical part of the softcloser.

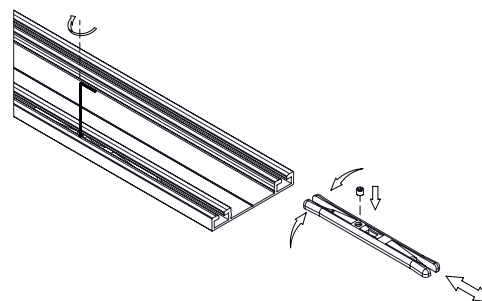

Montáž dorazů SOLID / Mounting of SOLID guides

V závislosti na zvoleném druhu pojezdových koleček / depending on chosen type

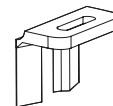

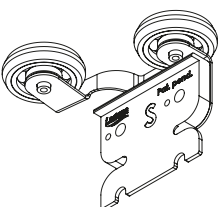
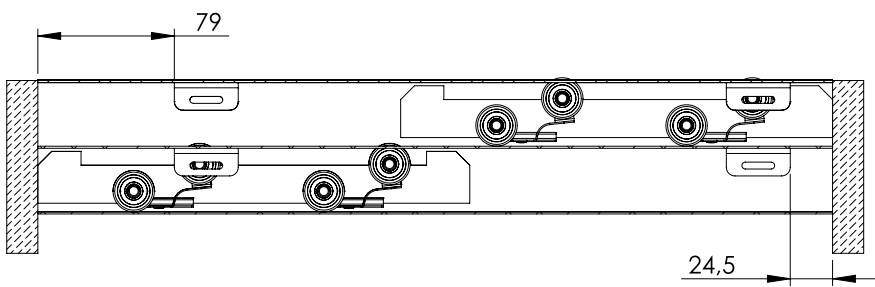
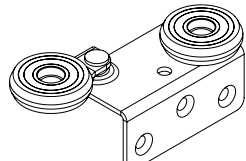
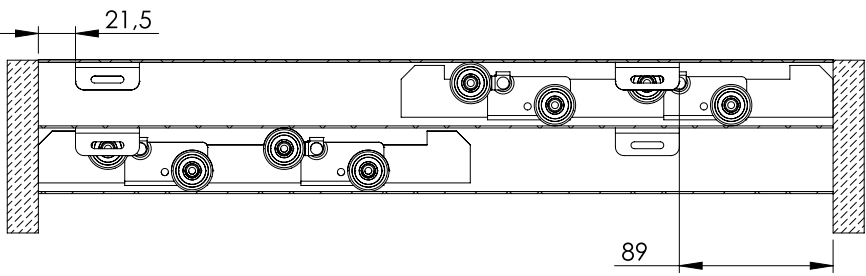
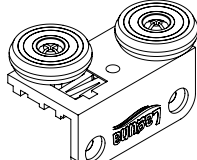
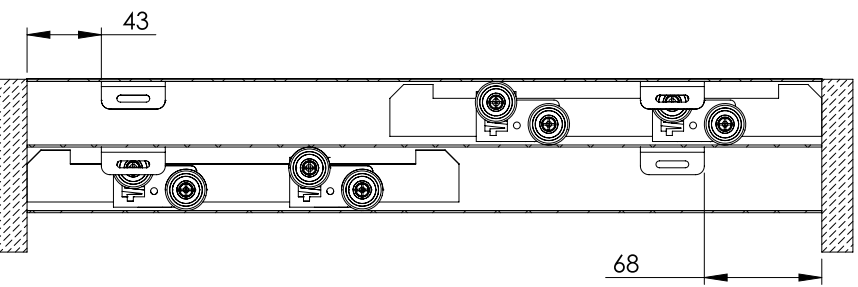
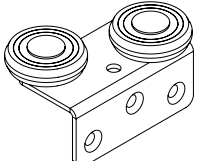
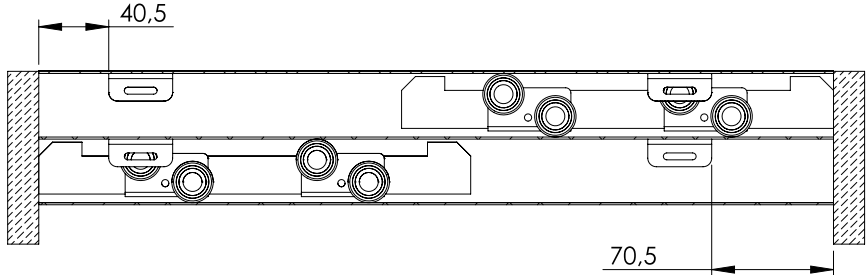
Druh pojezdových koleček / Guide type	Montážní rozměry / Mounting dimensions
	
	
	
	

Montáž dorazů ve vodicích kolejničích / Mounting of stoppers in the tracks

Pohled z vnitřku skříně / View from inside the wardrobe

Vpravo/ Right

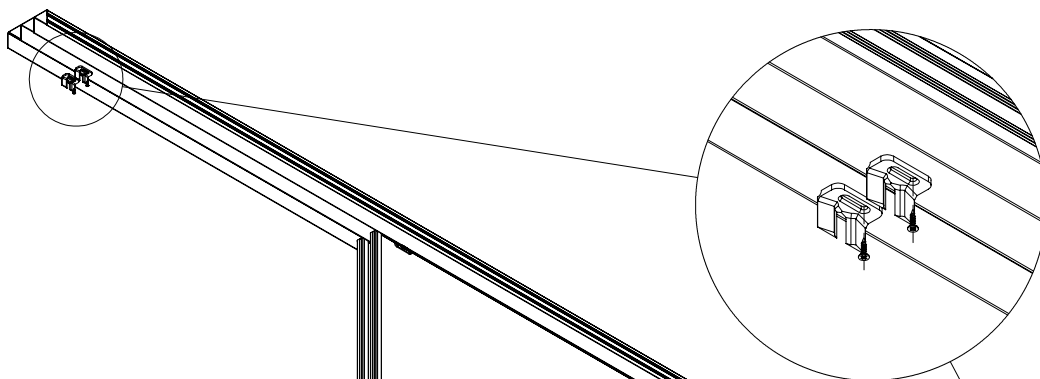

Vlevo/ Left

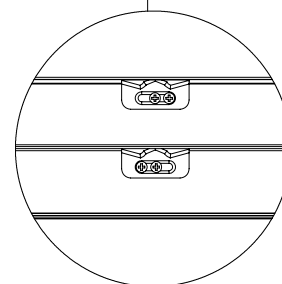
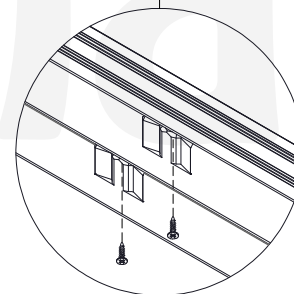
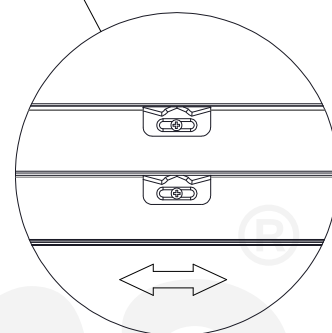
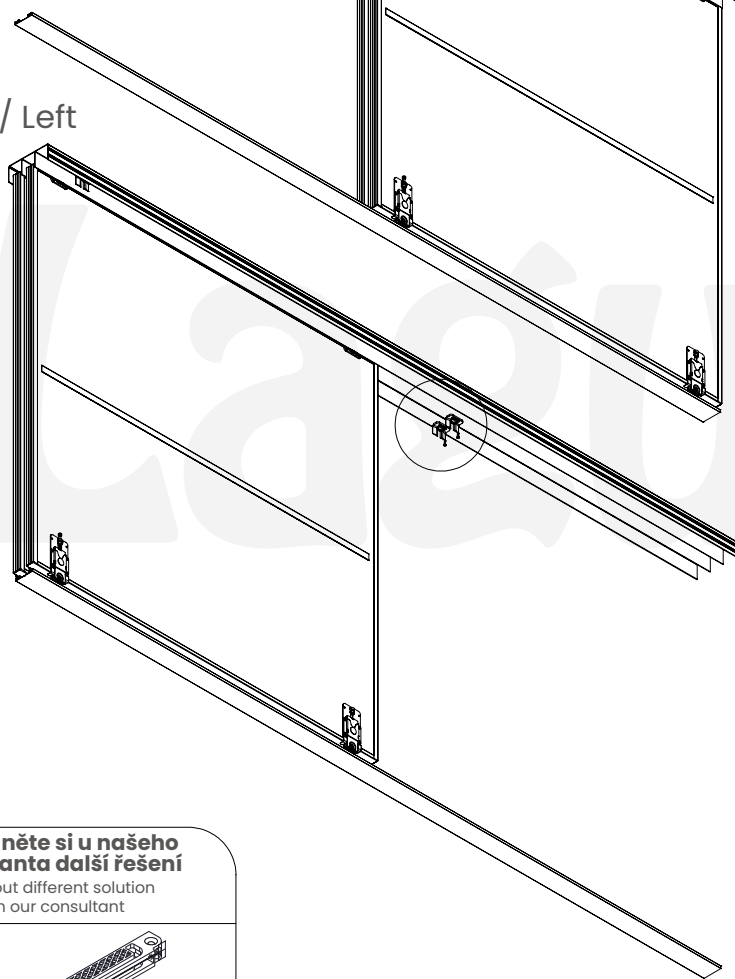

Prohlédněte si u našeho konzultanta další řešení

Check out different solution with our consultant

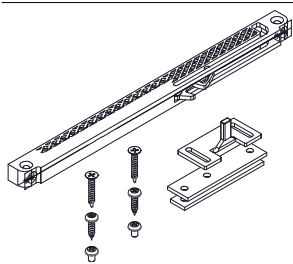

Doporučujeme postupovat podle těchto pokynů a používat příslušné nástroje podle doporučení. U součástí s ostrým povrchem je nutné používat osobní ochranné pomůcky a ochranu pracovního prostoru. Společnost Laguna Fabryka Okuć nenesse odpovědnost za jakékoli nehody vyplývající z nedodržení těchto pokynů.

It is recommended that you follow these instructions using the appropriate tools as indicated. In the case of elements whose surface can be sharp, use personal protective equipment and work area protection. The company Laguna Hardware Factory refrains from liability for actions resulting from conduct incompatible with this instruction.